

BAY AREA WOODWORKERS ASSOCIATION

MEETING ANNOUNCEMENTS

MARCH 1999

March 18 Meeting

3rd Thursday

REFRESHMENTS 7:00PM

MEETING STARTS 7:30PM

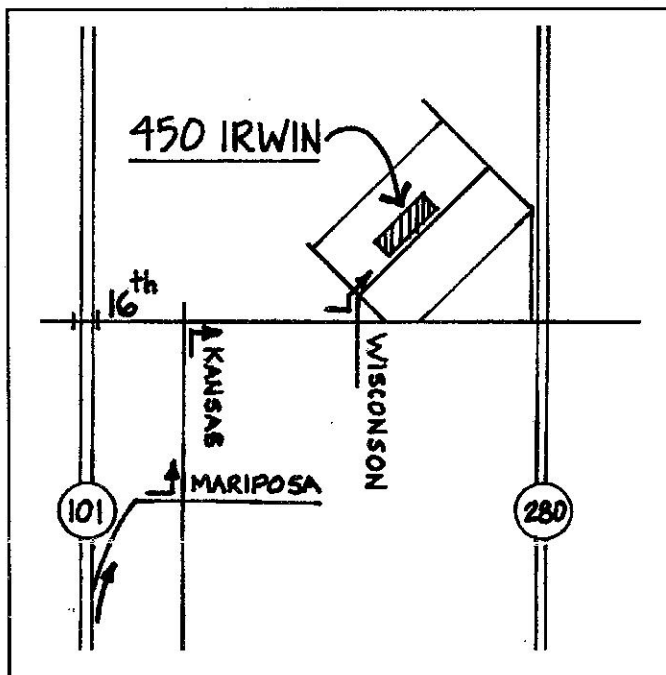

CALIFORNIA COLLEGE OF ARTS & CRAFTS (CCAC)

450 Irwin (Big gray building at 16th & Wisconsin), San Francisco 415/703-9523

Peter Pierobon of CCAC will lecture on his work and a little about CCAC. After starting at the Wendell Castle Studios, he received study fellowships from the PA Council of the Arts, the NY Foundation of Arts, etc. He's lectured at universities across the country and is widely published, and he has his work exhibited in the best galleries. On top of all this, he's a really nice guy! Come see the artistry in woodworking of Peter Pierobon.

Please don't disturb any classes going on - as CCAC's a busy place in the evening. Parking is on the street, with all the other students. The entry is at the middle of the 16th Street side. We'll meet upstairs at the far right end in the Wood Shop.

OFFICERS

President Mike Bray 510/595-8168
 Vice Pres. Linda Salter 650/365-4093
 Secretary Connie Voos 650/508-9384
 Treasurer Tony Fanning
 and Robie Fanning 650/323-1183
 Newsletter Craig Mineweaser .. 408/926-1900

COMMITTEE CHAIRPERSONS

Program Arnie Champagne .. 415/282-1704
 and Jay Perrine 408/367-8227
 Hospitality Vincent Dellachiesa .. 650/345-7529
 Membership .. Pending
 Shows Pending
 Outreach Bill Henzel 650/349-3062
 and Allen Harrison 415/873-4831
 Librarian Rodney Finlay 650/349-3766
 Webmaster Jim Voos 650/508-9384

For any questions or information about BAWA programs, contact Arnie Champagne or Jay Perrine.

LAST MEETING

by Connie Voos

President Mike Bray reminded all that BAWA members get a discount at tonight's meeting place, **Jordan International**, and that our video library will be kept here also. New members and guests introduced themselves (see p. 7.)

Treasurer **Tony Fanning** made a reminder announcement to pay your BAWA dues as soon as possible, if you have not done so already. Tony also announced the **B&A Exhibit** at the Legion of Honor in SF.

Vice President **Linda Salter** is hosting a toy making workshop at her shop on March 13 (See last month's News), and asked that as many as possible sign up now. She'll also be

(continued on page 6)

Upcoming 1999 BAWA Meetings

April 15 - Table and Chair Demo by Jeffrey Hunt

May 15 - Combined meeting with Peninsula Woodworkers

Have ideas for programs for '99? Call Arnie at 415/282-1704 or Jay at 408/327-8667. Make our meetings what you want them to be!

MEMBER FAVORITES

Have you got a favorite place for buying tools, lumber, supplies, etc.? Let the editor know so it can appear in this list.

Fine Lumber

Tony Fanning's Pick:

Southern Lumber Fine hardwood selection. Tony says, "In the '80s ...people snorted vast quantities of money up their noses; at the turn of the century, I blow away vast quantities of money on overpriced hardwoods. ...Ok, so it's a guilty pleasure." Go to 1402 Monterey Rd., (408/374-4664) and prepare to be wowed.

Nail Gun Supply & Repair

Jay Perrine's Pick:

Fas-n-Go offers best repair and supplies for all types of nail guns. They're at 539 E. Brokaw Road, San Jose or call 800/937-2255.

(Note: This is not an endorsement by BAWA. It is the sole opinion of the member(s) listed.)

We'll soon be publishing these "picks" as part of a resource list. So call or send additional ones to the editor! (See form on page 3.)

SEND IT IN

Have something you want published in this newsletter? Tell our members about: Ideas for future meetings, photographs, announcements, exhibits, shows or events. Or let the editor know if a mistake has been made.

Send to:

BAWA Newsletter Editor

3251 Almansa Court

San Jose, CA 95127-1001

or

408/926-1900 voice

408/926-7078 fax

researchchem@msn.com e-mail

Next issue DEADLINE:

March 31, 1999

page 2

BAWA EVENT HORIZON

Starting this month, our new Outreach Co-chairs, **Bill Henzel** and **Allen Harrison** will be organizing four toy making sessions in members shops. Here's our first one:

Toy Making Party!

on

Saturday, March 13, 1999

approx. 9am - 4pm

At BAWA member

Linda Salter's Shop

Linda will instruct us in the art and fun of wooden puzzle making. Our goal is to assemble and paint as many puzzles as possible while having fun! Call Bill Henzel 650/349-3062, Allen Harrison 650/873-4831, or Linda Salter 650/365-4093 for details, directions, etc. (NOTE: We'll need additional scroll saws for this event. Let Linda, Allen, or Bill know if you can bring yours. We'll also need 1/2" or 1/4" paint brushes. 3/8" Baltic Birch plywood backing boards will be supplied, but bring any hardwood scraps you may have.)

KNOW OF A WOODSHOP OR PRESENTER?

Do you know of a really great shop you'd like BAWA to visit, or an interesting presenter you would like us to have at one of our meetings? Call the Program Committee (either **Arnie Champagne** at 415/282-1704 or **Jay Perrine** at 208/327-8667) and they'll get it on our itinerary or monthly meeting.

CHRISTMAS IN APRIL

Remember to sign up to help with 'Christmas in April' by calling **Allen Harrison** of the Outreach Committee at 415/873-4831. He'll let you know the date, and you show up prepared to work on one of the many houses being renovated by volunteers throughout the Bay area. Its fun and it really helps the community and the lucky, low-income person who gets to live in the completed house.

NOTES ABOUT THIS ISSUE

by The Editor

1. **CHECK YOUR MAILING LABEL** on the back cover. See the date above your name? That's the date for you to renew your membership in BAWA. Fill out the renewal form on page 3 and bring or send it with your dues. If you haven't joined yet, it won't have a date on the label and it means that you must join soon as you'll only be receiving one more newsletter after this one. Keep the fun happening - join today!
2. We've added another advertiser this month, **Warren Wise** of **THE WOODSMAN**. Warren has presented to our group several times. **WELCOME WARREN**. Members, be sure to patronize these advertisers, and tell them you saw their ad in the BAWA Newsletter.
3. Thanks to members **Connie Madera Voos** and **Tony Fanning** for contributing to this issue.
4. Lastly, many of you who are familiar with the profile story we often run called "**Meet BAWA Member:.....**" will notice we haven't done one in several months. This is because I haven't been able to fit it into my schedule lately. I look forward to beginning these again soon. In the meantime, since member **Carl Johnson** was our main presenter chronicled this month, you might want to review the profile of him in the November 1998 issue of BAWA News.

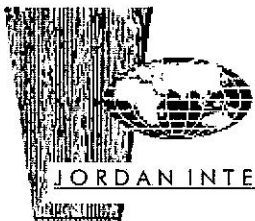

EXPORTS . IMPORTS
TIMBERS
OF THE WORLD

JORDAN INTERNATIONAL COMPANY

Offering wholesale and con-
tractor prices to **BAWA**
members

PHONE: 650/592-7725
FAX: 650/592-7729
1303 ELMER STREET
BELMONT, CA 94002

THOSE "PICKS"

See the "Member Favorites" list on page 2?
Well, soon we would like to collect these
"picks" and publish them as part of a list to
give to members when they first join or re-
new. So call or send additional ones to the
editor. Find unusual places and send as many
as possible!

Dear Editor: This is my favorite place
to get tools, lumber, or

(circle one, or fill in blank)

because (what do you like about it?):

Their address, phone and/or website:

Company

Street

City/State/Zip +4

Phone (____) _____ - _____

Website address

Send to: BAWA Newsletter Editor, 3251
Almansa Court, San Jose, CA 95127

EDUCATION CORNER

Making a Wooden Plane

on

April 3 & 4, 1999

Taught by

BAWA member

Arnie Champagne

Call 415/282-1704 for details,
fees, directions, etc.

You saw his demonstration at the
Janaury meeting, now come
experience with Arnie how much
fun this can be.

Making a Wooden Plane

on

April 17 & 18, 1999

Taught by

BAWA member

Arnie Champagne

Call 415/282-1704 for details,
fees, directions, etc.

Both of these classes in March
are full, so sign up now for the
April classes. Have a fun experi-
ence and learn a new technique!

TELL US ABOUT YOU!

**Your ad
here!!!!**

Beginning this month we're offering ad spaces in this newsletter. For only \$100.00 per year (12 issues) you'll get a business card sized ad approximately the size shown above. And we're offering a special introductory rate of \$75 for this first year! Our newsletter goes to a very targeted audience of woodworkers who buy tools, supplies, lumber and materials, and who attend seminars and related events. So if you're a supplier or service provider and want to reach this audience, all we need is "camera ready" copy 3 1/2" wide by 2" high. Call for a quote on larger add spaces. Call the Newsletter editor at 408/926-1900.

Membership?

from the Editor

WHAT DOES BAWA DO FOR YOU?

Recent presenters at BAWA meetings have included Sandor Nagyszalanczy, Brain Boggs, Tony Lydgate, *Berkeley Mills*, *DeWalt Tools*, Jaap Romijn, and Yeung Chan to name just a few.

BAWA also has an extensive and growing video library, and is building a formidable book & periodicals library. We even have a *Tormek* Grinder for loan to members. As a member, you not only get access to all of this, you make some great woodworking friends who are always ready to help you with a word of encouragement or an acknowledgment of your success. If all of this is worthwhile to you, then sit down right now and fill out the form to the right to join or to renew. Then either bring it with your check to the next meeting and give it to the treasurer, or mail them to her at the address listed below.

If you're a new member, welcome!

If you're renewing, thank you, and remember we still need the info, so fill out the form and send it in.

BAWA: Who We Are

The Bay Area Woodworkers Association was formed in 1982 by a small group of dedicated people who felt the need to strengthen the woodworking community by holding regular meetings, establishing an informal forum for the exchange of knowledge and ideas, sponsoring shows and meeting others in woodworking and related fields. Since then, this non-profit organization has grown to many members.

BAWA meets on the third Thursday of the month at 7:00 PM. Meetings usually have a specific topic, such as router techniques, finishing, turning, or business aspects of woodworking; or focus on a distinguished guest speaker who gives a presentation in his area of expertise. Meetings are held at woodworking shops and businesses in the Bay Area or at a permanent club meeting place (as soon as a new one is found - See notice on page 8.)

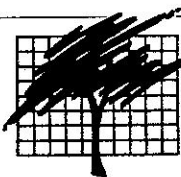

BAY AREA
WOODWORKERS
ASSOCIATION

Membership Application / Renewal

Name _____

Address _____

City _____ State _____ Zip +4 _____

Work Phone () _____

Home Phone () _____ Ext _____

Profession: _____

Specialty/Interests (List): _____

Skill Level: ☐ Professional ☐ Amateur ☐ Beginner

☐ Please don't circulate my name/address to other organizations.

I would be willing to volunteer for:

- | | |
|------------------------------------------------------------|---------------------------------------------------------------|
| <input type="checkbox"/> Elected Officer | <input type="checkbox"/> Greeter for Guests/New Members |
| <input type="checkbox"/> Program Committee or Chairman | <input type="checkbox"/> Hospitality for Guest Speakers |
| <input type="checkbox"/> Special Events Coordinator | <input type="checkbox"/> Meeting Set-Up/Clean-Up |
| <input type="checkbox"/> Organize Tours-Woodworkers' Shops | <input type="checkbox"/> Making <i>Toys for Tots</i> projects |
| <input type="checkbox"/> Trade Show Staff | <input type="checkbox"/> Outreach and Community Projects |
| <input type="checkbox"/> Show and Exhibit Coordination | <input type="checkbox"/> Librarian for Video Library |
| <input type="checkbox"/> Newsletter articles or Editor | <input type="checkbox"/> Handling AV Equipment |
| <input type="checkbox"/> Publicity for BAWA in Local Press | <input type="checkbox"/> Other |

Check as many as you want, but check at least one.

BAWA Membership Dues

BAWA dues are currently \$25.00 for twelve months (family memberships are \$30.00). Your newsletter address label shows your renewal date.

Membership can begin during any month of the year. Make check payable to BAWA. Bring it AND THIS FORM to the monthly meeting, or mail to:

BAWA TREASURER
632 Bay Road
Menlo Park, CA 94025

Membership Application/Renewal

LAST MONTH'S PRESENTATION

by Craig Mineweaser

Editors Note: Tony Lydgate, who was to present "The Art and Business of Craft" was unable to get to our meeting due to illness. So at the last minute, longtime BAWA member Carl Johnson and beginning box maker Vincent Dellachiesa teamed up to present a great show on making wooden boxes. We hope Tony is feeling better and wish him well in his new venture in Hawaii.

Carl Johnson has been making and selling boxes for many years. He has perfected a technique of making fine humidors, jewelry boxes and other fairly large boxes. Carl showed slides of Vincent Dellachiesa of the entire process of Vince making his first two boxes in Carl's shop.

"The bandsaw is the most important tool in the shop!" says Carl. Using a Delta 14" bandsaw with extension blocks, Carl re-saws the wood to make his own veneers using a 1/2" wide, 4 tooth/inch, high quality blade. These veneers are quite thick and he uses them for the top and bottom of his boxes. A discussion ensued on the details of veneering. Knowledgeable members of the audience agreed it's important to keep the blade sharp and very clean at all times. Set the blade to have minimum tension on the wheel, so that it will track correctly. Carl carefully sets up a full-length guide fence: "After marking a straight line where I want the cut, I start it through the saw a ways. You'll have to angle the board slightly to stay straight on the cut. Then I shut down the saw and clamp my fence (at both front and back of the table) at whatever angle the board is setting at. I can then start cutting the thin veneer from this point." He clamps his full-length fence, extending completely across the table, at both ends to assure rigidity. "I tried the point fence [as recommended in many books on cutting veneers] - it doesn't work. The secret is to support the wood the full length of the table. I even mount a full height backer-board to the front of my fence to give me support for the full height of the piece I'm cutting." Carl's series of slides showed Vincent cutting the veneer for the box Vincent was making.

Carl offered tips about the bandsaw based on his years of experience, such as, "Get as much horsepower as you can, but (remember) it's the blade that makes the difference." On picking

pieces of lumber to make into veneer he says, "cut a sample board, if the kerf pinches or flares, the wood is 'case hardened' from improper drying and you don't want to use it." After cutting the veneer, Carl's slides showed Vincent applying glue to all the veneers for the entire box at one time, placing a veneer on each side of a core board, then layering the boards in newspaper. Carl said a plastic spatula, such as the kind used in car body repair for applying Bondo works great to spread the glue evenly across the surface. Carl said that as soon as you place the veneer on the core board, roll it out to remove any bubbles, then go on to the next one. Carl pointed out that the veneer is slightly smaller than the core board, and that the grain of the veneer matches on both sides of each piece so when you open the completed box, it looks like solid wood. As you complete each piece, stack it on top of the others with a newspaper separator. Then clamp the entire stack. Use a glue with reasonable drying time, but work quickly. Carl uses an aliphatic resin glue such as Tite Bond or Tite Bond II. When the gluing is complete, clamp the entire sandwich of layered veneers and core-boards and let them dry.

When dry, Carl planes the surface of the veneer using a "carrier board" such as 3/4 thick Melamine surfaced particle-board. "You can paste wax the board to get stuff to run through [easily]." When the pieces were assembled to form the

box, we could see a rabbit had been placed in each corner allowing for the installation of a piece of 1/2" by 1/2" solid wood strip on all the edges. This strip can be matching or contrasting color to the rest of the box. It's function is to add rigidity to the assembly and protect the veneer edges from damage. Rounding it over with a router bit will keep it from getting dinged.

The lid is cut off the box after assembly. Vince did this on the on the band saw by taping in small wedges to keep the saw kerf open evenly all around. An audience member suggested setting the tablesaw blade to just below the thickness of the box walls, cutting all around, then after opening the box, finishing the cut edges with hand tools. Carl says, "Think bandsaw, not table saw, [and you can do the entire box making process with more control.]"

Carl makes the partitions inside the box of 3/8" Thin-ply plywood, or other good grade of plywood. He says, "Make sure the grain is perpendicular to the last layer below or it won't act like solid lumber anymore." At the end of the presentation, Carl passed out a typical layout drawing he'd done of a box, showing the shapes of the pieces. Carl and Vince did a great job and we say, "Bravo" not only for pinch-hitting, but clearly showing us how to build great wooden boxes. We're all now equipped with the knowledge to get started on this in our own shops. Thanks guys!



888/712-3594

or

209/931-3293

2701-A North Alpine Road, Stockton, California 95205

Mail: 1814 McClellan Way, Stockton, California 95207



The members brought lots of "Show & Tell" items.



Program Chair Stan Booker (left) presented President Mike Bray (right) with a book on one of Mike's favorite woodworking subjects: "Making Wooden Spoons."



Good food and conversations were enjoyed by all.

Vignettes of our Annual Christmas Pot-luck Dinner Meeting

December 1998

(I finally found these missing photos of our party. Editor.) If you went to our annual party at the December meeting, you know what a great time we all had. If you didn't attend, you missed:

1. A chance to see many creative and well done wood projects.
2. Good food.
3. Meeting to 'just talk' with other members and their spouses.
4. Enjoying a few laughs about all we did in 1998.
5. Good food.
6. Hearing about 1999 programs.
7. Good food.
8. Election of officers and committee chairs.
9. Good food.

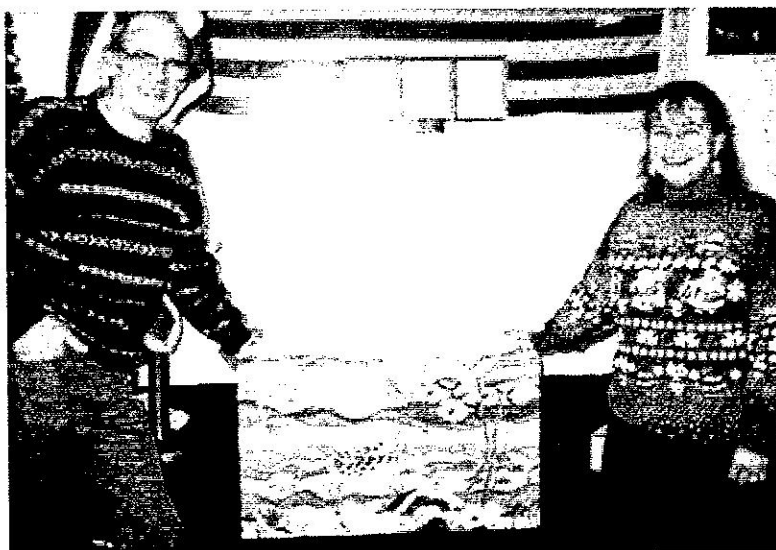

Richard and Linda Salter proudly display a painted wood toy chest they made for their grandkids. It has a colorful undersea theme painted on all four sides and the top.

NOT YET "BLOCKBUSTER VIDEO" BUT...

Now's your chance to order the latest (woodworking) hit movie on video. We currently have these video tapes in our lending library. We are hoping to get your ideas about what additional tapes you would like us to buy. Please fill out the form below and send it to our librarian Rodney Finlay at the address noted, so that he can add them to our library.

Also, if you have a tape you no longer need, that isn't on this list, won't you consider donating it to our library so our other members can view it too? Just bring it to the next meeting and give it to Rodney.

1. Bathroom Remodeling by Dean Johnson & Hometime
2. Build A Shaker Table by Kelly Mehler
3. Building a Log Cabin Home by Dean Johnson & Hometime
4. Carousel Horse Carving by Tom Wade
5. Dust Collection & Air Filtration by Onieda Air Systems
6. Furniture Refinishing by Dean Johnson
7. Hand Applied Finishes - Applying Top Coats by Jeff Jewitt
8. Hand Applied Finishes - Coloring Wood by Jeff Jewitt
9. House Framing by Dean Johnson & Hometime
10. Intarsia by Judy Gale Roberts
11. Making Mortise and Tenon Joints by Frank Klausz
12. Mastering Your Tablesaw by Kelly Mehler
13. Mastering Woodworking Machines by Mark Duginske
14. Router Jigs and Techniques by Maas and Fortune
15. Router Joinery by Gary Rogowski
16. Shop Secrets from Master Craftsmen by Dunbar, Eakes, Klaus & Truini
17. Small Shop Tips and Techniques by Jim Cummins
18. Tablesaw Tricks and Jigs by Kelly Mehler
19. Woodbending by Marc Adams
20. Woodturning (author unknown)

Okay, I read the above list of videos in our library, and I'm eager to rent one. But in the meantime I'd like to see BAWA buy the following video:

Video Title:

(be as specific as you can so we can find the title in the retailer's list)

Author:

(fill in if you know who the star is)

I think this video would be a good addition to our library because... (what do you like about it, or think you might like about it?):

Do you know where we can get this video? (eg. Taunton Press, Amazon.com, etc. If you don't know, it's okay, we'll try to track it down.)

Company _____

Street _____

City/State/Zip +4 _____

Phone (____) _____ - _____

Website address _____

Cut out this form and mail it to: BAWA Newsletter Editor, 3251 Almansa Court, San Jose, CA 95127 or send an email to: researchem@msn.com.

SHOW & TELL

At the February meeting, member **Arnie Champagne** had an interesting jig he shared with us. It's a strip of wood with a specially shaped groove in each side which allows you to safely hold a strip of wood to make those thin, continuous wood strips for holding the glass on the inside of your cabinet doors. You place the strip of wood you want to shape into the first groove and it allows you to quickly and safely shape the angled surface. Then you flip the holder over and place the angled piece in the square groove on the other side so you can hold it to finish shaping and sizing it. In no time you have a 'V' shaped piece with a flattened bottom on the 'V' to hold the glass. There's a brad at the end of each groove to stop the strip from moving while you're working on it. Ask Arnie to show it to you next time.

BAWA'S GROWING!

The following new members were at our Feb. meeting:

Name & City/Interests

J.T. Conklin, Daly City / toys, end tables, & blanket chests
Claude Godcharles, Menlo Park / furniture restoration
Marcus Gonzales, San Francisco / cabinetry & furniture
Bill Miller, Daly City / case work, lathe, small fancies
Magnus Nilsen, San Jose / has garage shop & builds boats
Don Pezzolo, Los Altos Hills / wood & metal working
Steve Schaffer, Foster city / traditional furniture
Bill Small, Danville / furniture

Additional new members this month:

Al Gilkerson, Hayward / professional box and display maker
Max Hensley, Burlingame / beginning woodworking
Daniel Snyder, Oakland /

Additional visitors at the Feb. mtg:

Vicky Ellis and her son **Matt**
Don Ellis who's starting a home shop
 Welcome to you all, and thanks for joining us!

San Mateo, CA 94402-5481
PO Box 5481

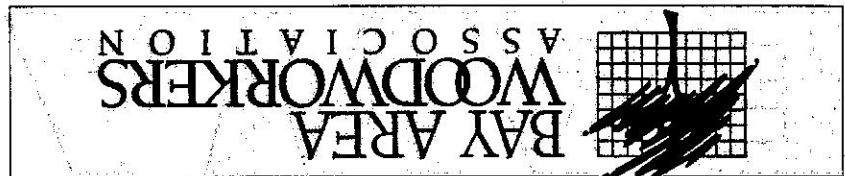

LAST MEETING

(continued from page 1)

working on the intra-club picnic for this summer. She asked for anyone interested in helping with this, to contact her at 650/365-4093.

Newsletter Editor **Craig Mineweaser** said in addition to newsletters sent to our membership, 125 copies of the February issue were mailed to those who signed up at our booth at the Woodworking Show in Nov. Craig printed new name tags for all. Check the bin for yours. He brought a set of run-off rollers to sell with proceeds to go the club. He also noted a correction on **Jay Perrine's** phone number listed on the front of the Feb. newsletter should be 408/367-8227. Craig also announced that the BAWA News is now running advertisements.

Stu Hoffer announced that he has the club's **Tormek Grinder**. Contact him if you want to rent it at his correct number: 650/940-6434.

Librarian **Rodney Finlay** announced

some additional tapes had been donated to our video library and he suggested that we put a form in the newsletter to ask the members what tapes they want the club to buy.

Webmaster **Jim Voos** said he's continuing to try to get a BAWA web site up and running. He is waiting on his DSL installation, which will make it much easier.

Outreach co-chair **Bill Henzel** explained that the toy workshop on the 13th is the first of four we'll be having this year. Each at a different workshop and making different toys. Co-chair **Allen Harrison** passed around a sign-up sheet for the "Christmas-in-April" project. Call him at 415/873-4831 if you'd like to join in the fun.

Member **Stan Booker** showed some sample stair balusters. A friend of his in Reading has over 100 of these, all different styles. He wants ideas on

what to make with them - perhaps we could incorporate them into our toymaking?

Program Chair **Arnold Champagne** reviewed the programs for the next 5 months: **Peter Pierobon** will lecture at CCAC in March. **Jeffrey Hunt** will do a table and chair demo in April. May will be a joint meeting with the **Peninsula Woodworkers**. In about July, members **Craig Mineweaser** and **Mike Bray** will do a presentation on drawing the furniture or other piece you want to build. Give Arnie any suggestions you have for future meetings. Also Arnie reminded members to bring "Show & Tell" items to our meetings, as we all learn from them. Arnie also announced that he would be holding another plane making class in April (*see p. 3.*), and reminded everyone of the variety of good woodworking classes available from local community colleges, etc.